

AVENTOS HK

Wood/wide aluminum door application

Lift mechanism set

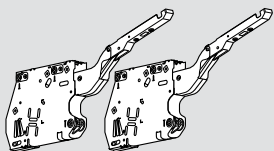

- Lift mechanism (qty 2)
- #7 x 35 mm (1-3/8") wood screw (qty 10)

Power factor	Opening angle	Part no.
43 — 99	107°	20K2300.N5
100 — 174	107°	20K2500.N5
175 — 349	107°	20K2700.N5
350 — 792	100°	20K2900.N5

Cover set

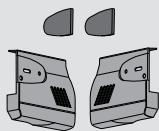

- Right and left cover plate
- Non-handed cover cap (qty 2)

Cover set	Part no.
Cover set	20K8000.NA

Wood or wide alum door hardware set

- Arm assembly mounting plate (qty 2)

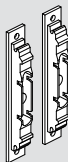

NOTE: Three hinges and mounting plates required for cabinet widths over 1219 (48")

Hardware set	20S4200
Inst. screw for wood doors	606N or 606P
Inst. screw for wide alum doors	7072A

Mounting plate with bracket set

- Left and right mounting plate with bracket
- For large overlay five-piece doors

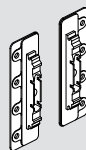

Mounting plate w/ bracket set	Part no.
Mounting plate w/ bracket set	20S4F01

Assembly

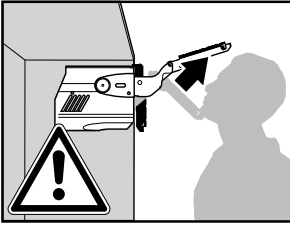

WARNING

Risk of injury from spring-loaded arm

- Do not push arm assembly down or leave in the down position
- Remove mechanism before installing or removing cabinet

1 Locating pin locations and minimum depth

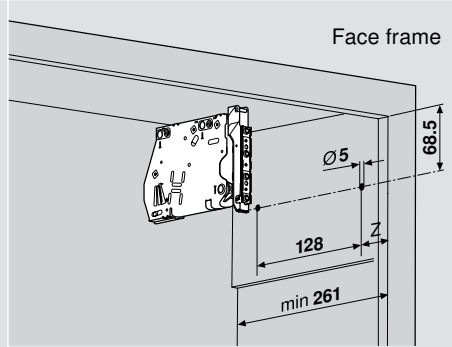
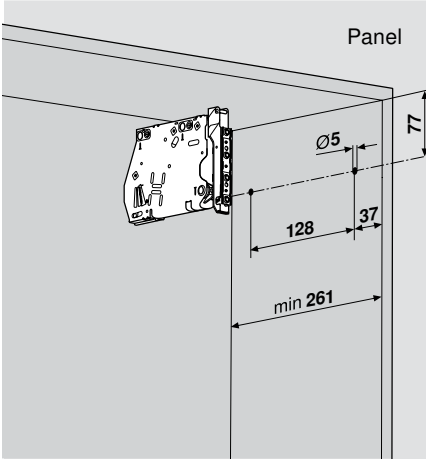

NOTE: Face frame cabinets must be blocked out flush with the frame.

Overlay	up to 28	32	35
Z	37	35	33

Part no.

AVENTOS boring template is available for pre-boring 5 mm locating pins

65.5020

2 Attaching the lift mechanism

- Use the AVENTOS template to pre-bore the locating pin holes for the AVENTOS HK lift mechanism
- After aligning the lift mechanism with the cabinet using the locator pins, attach the mechanism with the three mounting screws provided

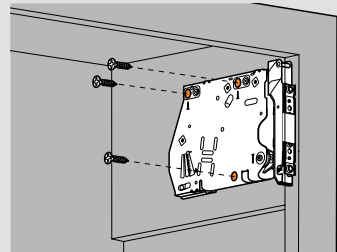

#7 x 35 mm (1-3/8") wood screws (qty 3)

3 Remove transport tab from lift mechanism and raise arms

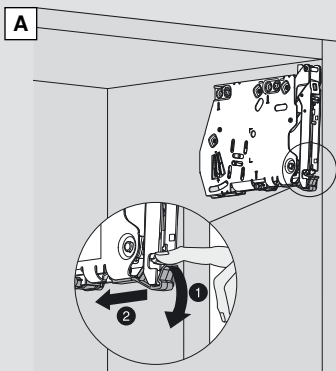

Carefully remove the transport tab.

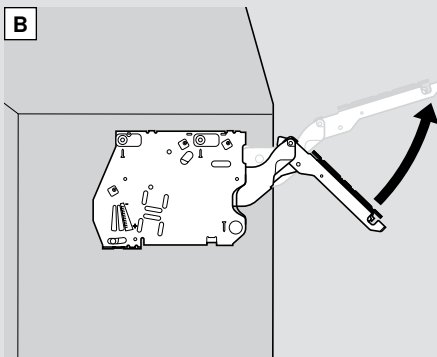

Raise the arm to the upright position.



Risk of injury from spring loaded arm.

NOTE: Do not remove transport tab until just before attaching the door

Attaching the mounting plates

4a For Wood/wide aluminum doors

Frame

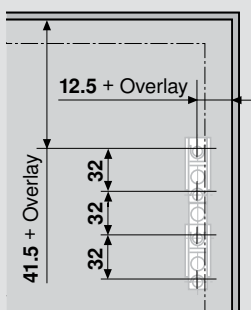

Panel

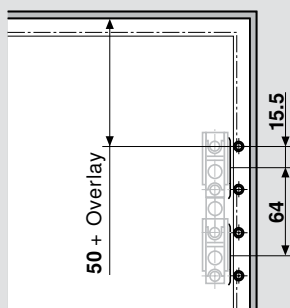

NOTE: All four screws must be installed

4b With bracket for five-piece doors

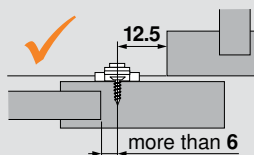

Standard mounting plate works

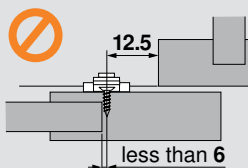

Standard mounting plate does not work

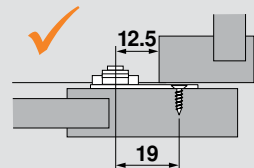

Use mounting plate with bracket when panel is < 6 mm from screw

Assembly

5 Attaching the door

Attach the door using the CLIP mechanism in the mounting plate.

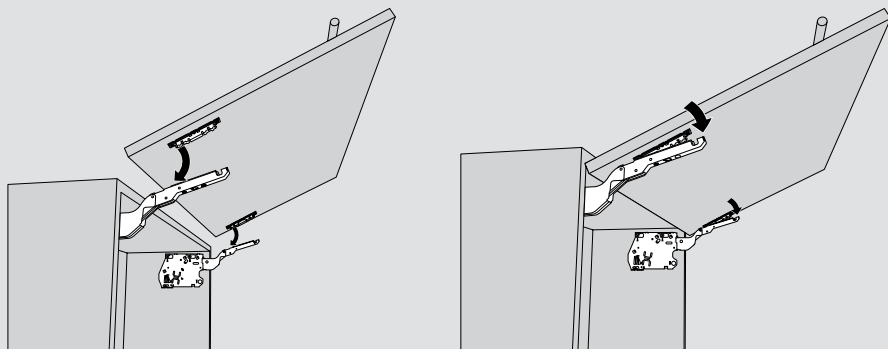

6 Adjust the door tension

Use a screw gun and #2 x 2 POZI driver bit to adjust the lift mechanism to the desired tension.

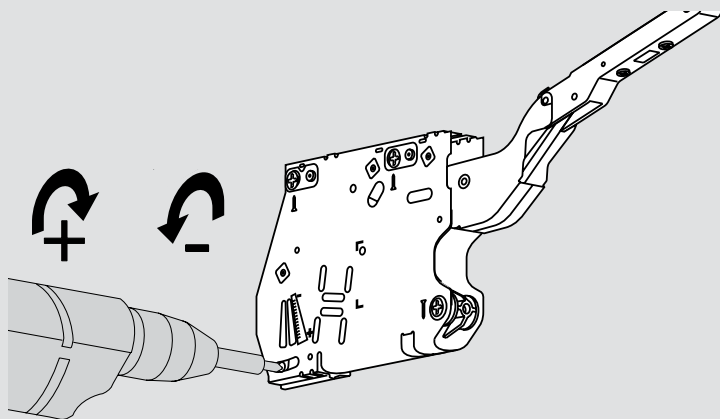

7 Finalize the door adjustments

Use a POZI screwdriver to adjust cam adjustments for each of the three-dimensional adjustments.

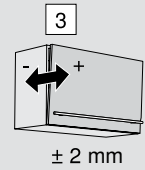
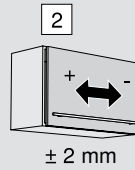
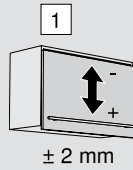
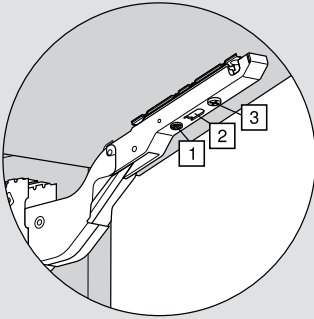

8 Attach cover caps

Snap the symmetrical cover caps on each cover plate. Place the left and right cover plates over the appropriate lift mechanisms and snap them in place.

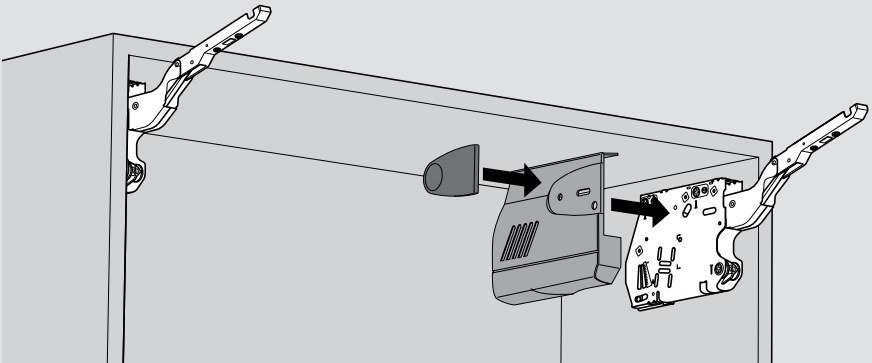

Removal

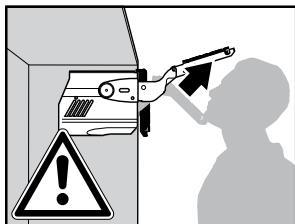

WARNING

Risk of injury from spring-loaded arm

- Do not push arm assembly down or leave in the down position
- Remove mechanism before installing or removing cabinet

1 Removing the covers

Remove the cover caps and cover plate.

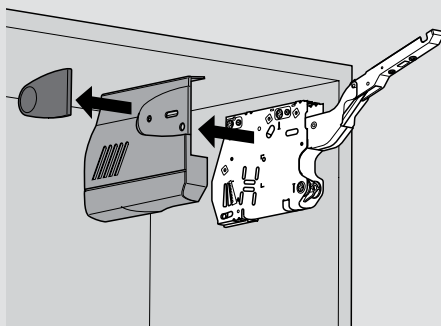

2 Removing the door

- Open the door. Use a screwdriver to disengage the CLIP mechanism of the lever arm from the mounting plate
- Support the door with one hand and repeat on the other side

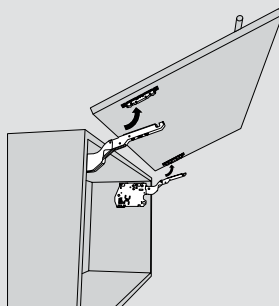
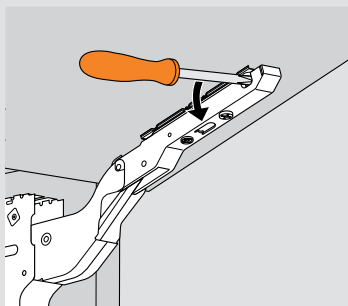

Other information

Panel door clearance

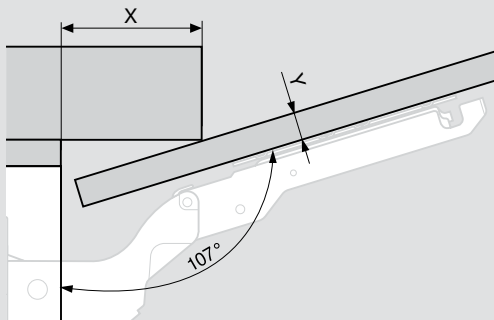

Door thickness	16	19	22	26
X	70	59	49	35

Face frame door clearance

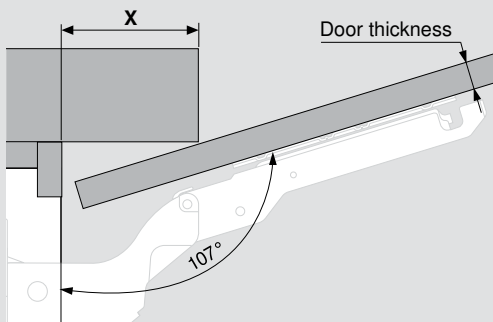

Door thickness	16	19	22	26
X	70	59	49	35

Inch		mm
1/32	.031	1
1/16	.063	1.5
3/32	.094	2
1/8	.125	3
5/32	.156	4
3/16	.188	5
7/32	.219	5.5
1/4	.25	6
9/32	.281	7
5/16	.313	8
11/32	.344	9
3/8	.375	9.5
13/32	.406	10
7/16	.438	11
15/32	.469	12
1/2	.5	13
17/32	.531	13.5
9/16	.563	14
19/32	.594	15
5/8	.625	16
21/32	.656	17
11/16	.688	17.5
23/32	.719	18
3/4	.75	19
25/32	.781	20
13/16	.813	20.5
27/32	.844	21
7/8	.875	22
29/32	.906	23
15/16	.938	24
31/32	.969	24.5
1	1	25.4

Blum, Inc.
7733 Old Plank Rd.
Stanley, NC 28164
800-438-6788
fax 704-827-0799
sales.us@blum.com
www.blum.com