



# 韓國三星電子鎖使用說明書

九江五金行

臺北市萬華區西寧南路 233 號

Tel : 02-2331-5987

[www.九江五金.tw](http://www.九江五金.tw)



Model : SHS-2320



**SAMSUNG SDS**

Samsung SDS  
**Digital Door Lock**

# User Guide



Intelligent Digital Doorlock

The safety section of this manual contains important information to ensure the user's safety and prevent potential damage to property. Please read this section carefully and use the product accordingly.

**SHS-2320**





# Product Features



## **Double Claw Bolt Ensures Robust and Safe Lock**

---

With double claw bolt, it prevents forced intrusion, ensuring your safety.



## **User-friendly Graphic Interface Allows You to Check the Status of the Doorlock**

---

When the user opens the door or sets up the modes, user-friendly graphic interface icons appear showing the user the status of the doorlock, making it convenient.



## **With Infrared Ray Sensor, Security Is Stronger**

---

When the door is unlocked from the inside without sensing any movement inside, the door won't open, strengthening the security against intrusion.



## **Anti-theft Function Ensures Worry Free Trip**

---

When going out, the user can set up the anti-theft function, which creates a warning sound when the doorlock operates, preventing any tempering.



## **Multi-level Security Code Entry Mode Is More Secure**

---

Passwords will be pressed after press two random numbers, preventing intruders from checking the fingerprint marks left on the pad and break in.



## **Double Authentication Function Is More Secure**

---

With double authentication mode set up, both password and card must be authenticated to open the door, strengthening security.



## **Other RF-enabled Cards as well as the Key Tag Provided Can Be Used to Open the Door**

---

Not only the key tag provided but also other cards with a radio frequency function can be registered and used to open the door. (Up to 20 cards can be registered.)



## **Passwords Can Open the Door**

---

Register desired password, and use it to open the door without any keys.



## **With the Built-in Fire Detection Feature, It Is Possible to Exit Promptly and Safely in Case of a Fire**

---

When a fire breaks out from the inside and temperature exceeds the normal level, a warning alarm will sound and the door will automatically open.



## **Door has Auto-lock Function**

---

Auto-lock allows the door to be locked automatically.



## **Double Lock System Is More Secure**

---

At night, it is best to use double lock function to lock the door.



## **Protects from Outside Tampering**

---

When trying to open the door with an unregistered card, key tag or password 5 times, the alarm will sound and the power will shut down for 3 minutes automatically.

# Table of Contents

<b>Product Features</b>	<b>1</b>
<b>Precautions</b>	<b>4</b>
<b>Read before Use</b>	<b>7</b>
Product Components .....	7
Outer Body Part Names.....	8
Inner Body Part Names .....	9
How to Replace Batteries .....	10
How to Use Emergency Battery .....	11
<b>Basic Functions</b>	<b>12</b>
How to Reset (Password, Card, Key Tag) .....	12
How to Register and Change Password.....	13
How to Register Card and Key Tag.....	15
How to Delete Card or Key Tag .....	17
How to Open Door from the Outside (Password) .....	18
How to Open Door from the Outside (Card, Key Tag).....	19
How to Open and Close the Door from Inside .....	20
<b>Additional Functions</b>	<b>21</b>
How to Set up Multi–leveled Security Code Entry Mode .....	21
How to Set up Infrared Ray Sensor .....	22
How to Set up Double Authentication Mode .....	23
How to Set up Auto/Manual Lock.....	24
How to Set up and Turn off Sound.....	25
Warning Alarm / Emergency Alarm .....	26
<b>Troubleshooting</b>	<b>30</b>
<b>Summary of Usage</b>	<b>32</b>
<b>Product Specifications</b>	<b>34</b>
<b>Product Warranty</b>	<b>35</b>

# Precautions

The following contents are designed to protect user safety and prevent loss and damage of their property. Please read this prior to use to ensure the product properly used.

## Meaning of Warning, Caution, and Reference



### Warning text

Provides user information to prevent physical damage.



### Things to Be Cautious of

Provides user information to prevent system error or system damage.



### Things to refer to

Provides additional information regarding each topic.

## Meaning of Each Symbol



Indicates warnings or cautions.



Indicates banning miss-use of the product.



Indicates special instructions for the user.

## Cautions Regarding the Installation



Do not install or disassemble on your own.

If users install or repair on their own, the company will not be responsible for any damage.



Do not install where the gap between door and door frame is bigger than 5mm.

May not work well if large gap exists.

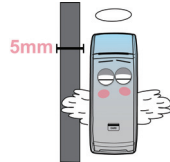

## Caution While in Use



Do not let others know the password. Change it periodically.

This is done to prevent a potential break-in.

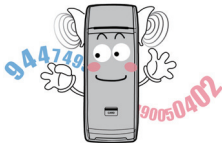

Please do not use the product with wet hands, and make sure that liquids such as water or a beverage do not get inside the product.

This may result in a malfunction or damage to the product.

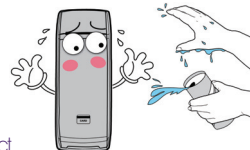

Do not push the buttons excessively hard or with a sharp object.

This may result in a malfunction.



Please check if the door is locked before you leave.

The company will not be responsible for accidents resulting from an unlocked door.

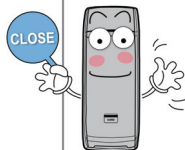



## Cautions Regarding Repair and Maintenance



Insert batteries with correct (+/-) directions.

If the battery is not properly inserted, it might lead to a leakage or explosion.



When replacing the batteries, please replace all the batteries at the same time, and do not mix new batteries with used ones.

Product can be damaged or its lifespan can be reduced.

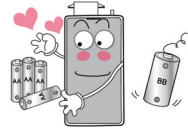

When cleaning the product, please do not use water, benzene, or alcohol; instead, please use a soft, dry cloth.

There is a risk of damaging the product.



When the product sounds to indicate the need for a battery change for the first time, please make sure to do so within one week.

If the batteries are not replaced on time, it may only be opened with the emergency key.



# Read before Use

## Product Components



Outer body



Inner body

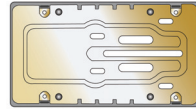

Inner body holding panel



'AA' batteries (LR6)



Screws to ensure fixture between the panel and the outer body



Self-drilling screws to hold panel



Strike



Key tags



Screws to hold the fixtures from the inside

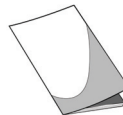

User Guide



Note

– Product composition can be different and subject to change without notification.

# Outer Body Part Names

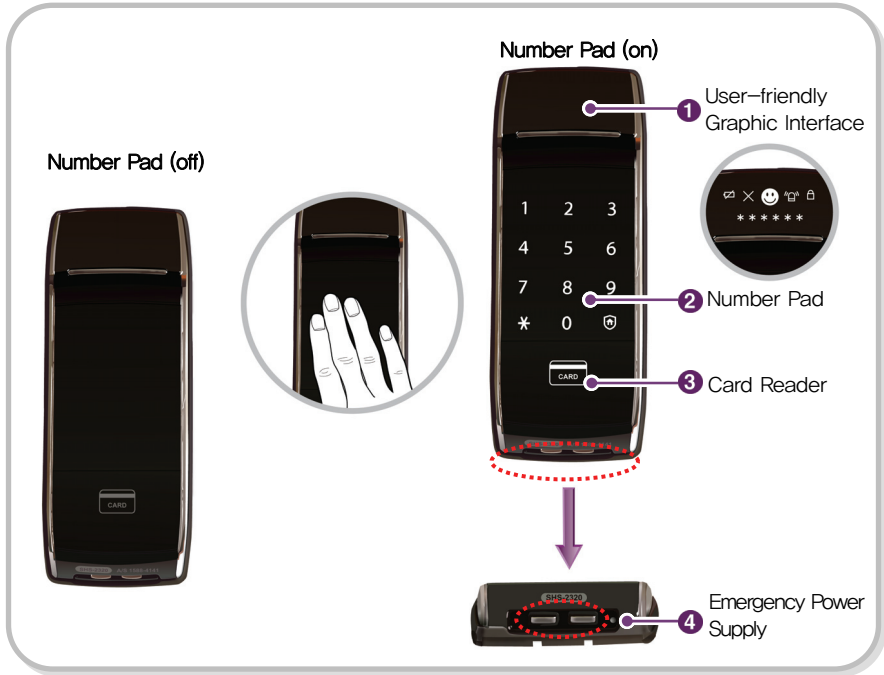

No.	Part	Function
1	User-friendly Graphic Interface	Shows the status of the doorlock function.

	Battery Change Time Notification		Double Lock Mode Being Setup
	Password or Card Authentication Failure/Registration or Setup Failure		Password or Card Authentication Success/Registration or Setup Success
	Intrusion/Fire/Security Breach Incident	* * * * *	Word Count of Password Entered

2	Number Pad	Press to change password or to select or delete it. Use number pad to enter the password and open the door.
3	Card Reader	The place to read cards or key tags to unlock the door. Touch the number pad to activate the Card reader.
4	Emergency Power Supply	Gives power in case of complete discharge of batteries with the connection of an emergency battery. (Use 9-volt battery.)

## Inner Body Part Names

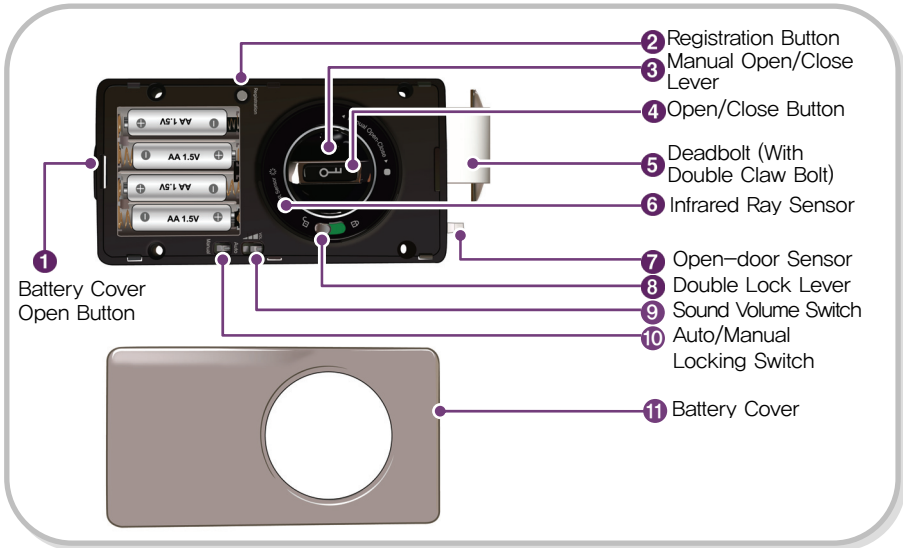

No.	Part	Function
1	Battery Cover Open Button	Button used to open the battery cover.
2	Registration Button	Button used to register/change password, card, key tag.
3	Manual Open/Close Lever	Lever used to lock or unlock the door manually in case of any electrical failure.
4	Open/Close Button	Button used to open and close the door.
5	Deadbolt (With Double Claw Bolt)	Device that locks the door at the door frame with double claw shaped bolts.
6	Infrared Ray Sensor	When pressing Open/Close button, the red light will appear if the sensor detects normal environment. (If infrared ray sensor is not activated, the light will not appear)
7	Open-door Sensor	Sensor that detects open/close status after auto-lock mode is being set up.
8	Double Lock Lever	Lever that prevents any opening from the outside with password, card or key tag.
9	Sound Volume Switch	Switch that adjust the volume of sound.
10	Auto/Manual Locking Switch	Switch that converts from Auto-lock to Manual-lock or vice versa. If it is at auto-lock position, the door locks automatically. If it is at manual-lock position, closing the door does not automatically lock the door.
11	Battery Cover	Cover that protects batteries and registration button.

# How to Replace Batteries

## 1. When the Low Battery Ring Tone Sounds



If the melody "Fur Elise" rings before the door opens with password or key tag, it is time to replace batteries (The replace battery icon  at the user-friendly graphic interface will light up after the low battery ring tone sounds)



Note

### Battery Lifespan

Battery lifespan is different depending on its manufacturer, manufacturing date, and use environment. Use 4 1.5volt AA Alkaline batteries and batteries last 10 months with an average of 10 uses a day.

## 2. Opening Inner Body Cover

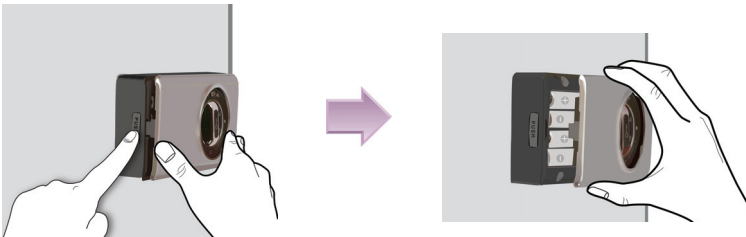

Press the battery cover button lightly and pull the cover to open.

## 3. Replacing Batteries



Please replace all 4 batteries with new ones within a week.

- The product may shut down without warning if the battery is not replaced promptly after the replace battery sound.



Caution

- If the battery is not inserted correctly, the door lock will not work.
- Leakage from the battery may harm the product, so please check the battery regularly (about once every six months).
- Until the battery is replaced after the replace battery warning sound, functions like register, change, or setup of password/card cannot be used.

# How to Use Emergency Battery

## 1. When Door Will Not Open Due to Complete Discharge of AA Batteries

When it is time to change the batteries, if not replaced, the door lock will not function normally.



## 2. Purchasing a 9V Battery



Purchase emergency battery (9V) at the nearest convenience store or electronics shop.



Caution

- Use alkaline batteries that last longer than normal manganese batteries or rechargeable batteries.

## 3. Opening Door Using Emergency Battery



Place 9V battery emergency battery at the connection point, then place card or key tag on the Card reader or enter password.

# Basic Functions

This section explains ways to reset the data in the doorlock system, ways to register password, card and other information and ways to open and close the door.

## How to Reset (Password, Card, Key Tag)

Delete all data (about password, card, and key tag). When data is being reset, password will be '1234' and previously registered information on card, key tag and password will be deleted.



Note

- Reset the door lock data and re-register new password and card.
- Resetting can only be done while the door is open.

### 1. Opening Cover



Press the **[battery cover open]** button lightly and pull the cover to open.

### 2. Pressing [Register] Button



Ding dong → Ding ding → Ding ding

Press **[Register]** button for 10 seconds.

### 3. Entering Password



Success:  
Ding dong  
dang

Press current password or '4560852580' and then press **[\*]** button.

# How to Register and Change Password

Password can be registered with 4~12 digit numbers, and only one can be registered and used. If the password needs to be changed, changing procedure is the same as that of registering password.



Note

– Changing password can only be done while the door is open.

## 1. Pressing [Register] Button



Open the battery cover and press **[Register]** button briefly.



## 2. Entering Current Password



Enter current password (initialized password is '1234') and then press **[\*]** button.

## 3. Entering New Password



Enter new password (4~12 digits) and then press **[\*]** button.

- On the user-friendly user interface, number of digits entered during the registration of the password will appear and if the number of digits is more than 6, the numbers will light up in order.
- To prevent theft, it is highly recommended that a password with more than 6 digits is used. (Only numbers from 0~9 can be used.)



## 4. Re-entering New Password



To check the registered or newly entered password is entered correctly, enter the new password again and then pressing [**\***] button will complete the procedure.

- If registration of password completes, 😊 icon will light up on the user-friendly graphic interface.

## 5. Confirmation with New Password



To check the new password is successfully registered, enter the new password before actually closing the door.

- To check the new password, while the door is open, press the open-door sensor, and when deadbolt comes out, follow the procedure of "How to Open Door from the Outside (Password)" Section in page 18.
- If the door opens normally, 😊 icon will light up.



### Caution

- Do not let others know the password. Using the same password for a long time may cause a breach, so change it periodically to prevent break-in.
- Registered password cannot be deleted and can only be changed with new password or deleting all information (password, card, and key tag) by resetting them and re-registering new information and use.

# How to Register Card and Key Tag

The total number of 20 including key tag can be registered.  
(ISO14443A Type Compliance)



Note

- Registration of cards or key tags can only be done while the door is open.

## 1. Pressing [Register] Button



Open the battery cover and press **[Register]** button briefly.



## 2. Entering Current Password



Enter current password and then press **[\*]** button.

## 3. Contacting Card or Key Tag



Hold card or key tag to be registered up to the outer body card reader, the registration will be completed with “ding dong dang” sound.

- If registration of card completes, 😊 icon will light up on the user-friendly graphic interface.

## 4. Completion of Card Registration



Press **[Register]** button on the inner body to complete registration procedure.

## 5. Confirmation of Card/Key Tag Registration



Touch **[Number Pad]**, and then place registered card or key tag on the Card reader.

- Follow the procedure of "How to Open Door from the Outside (Card, Key tag)" Section in page 19.
- If the door opens normally, 😊 icon on the user-friendly graphic interface will light up.

## To Register Additional Card

### Continuous Registration



To register multiple cards, after the previous card, place others within 10 seconds of each other.

If no card is placed within 10 seconds, the procedure will end automatically.

### Later Registration

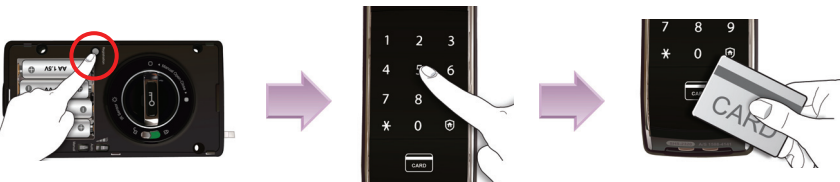

If additional cards or key tags are need to be added after the initial registration of cards, the registration procedure must be followed.

# How to Delete Card or Key Tag



Caution

Registered card cannot be deleted individually, and can only be deleted with all the cards and key tags if card delete function is used. After applying the card delete function, pre-registered cards cannot be used to open the door.

## 1. Pressing [Register] Button



 Ding dong → Ding ding

Open the battery cover and press **[Register]** button for 5 seconds.



## 2. Entering Password



 Ding dong dang

Enter password and then press **[\*]** button.



Note

- Register and use new cards after delete card information.
- If all card information has been deleted, use registered password to open the door.
- Deleting card information can only be done while the door is open.
- If all card information is deleted, double authentication mode will be deactivated.

# How to Open Door from the Outside (Password)

From the outside, the password can open the door. Touch [Number Pad] and open the door with the registered password.



Note

- When purchased, the product is initially set to multi-leveled security code entry mode but double authentication mode is not activated.
- If normal mode is to be set up, please refer to “How to Set up Multi-leveled Security Code Entry Mode” on page 21.

## 1. Touching [Number Pad]



Touch [Number Pad].

## 2. Entering password

### Multi-leveled Security code entry mode

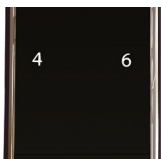

Press 2 number buttons that randomly light up.

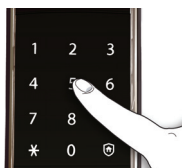

When the light comes on, on the number pad enter the password and press [**\***] button.



Success: 1Ding dong dang dong  
Fail: Ding dong ding dong

### Normal mode

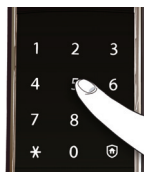

Success: 1Ding dong dang dong  
Fail: Ding dong ding dong

When the light comes on, on the number pad, enter the password and press [**\***] button.



Note

- Password must be entered after the light is on, if it does not then touch [Number Pad] and re-enter.
- To cancel after a wrong entry, press [**⏏**] button and re-enter.
- If the password is wrong 5 times, "piririri" warning alarm will sound for 10 seconds, and the system will shut-down for about 3 minutes. When stop mode occurs, "beep" will sound every 10 seconds, and stop mode will be deactivated automatically after 3 minutes of multiple 'beeps'. With stop mode, the user-friendly graphic interface will show the duration time by turning off [**\***] icon one at a time every 30 seconds.

# How to Open Door from the Outside (Card, Key Tag)

Use a card or key tag to open the door from the outside. Touch [Number Pad] and open the door by placing a registered card or key tag.

## Placing Card or Key Tag



Touch [Number Pad].

When the light is on the number pad, place a card or key tag on the Card reader.

The door opens in a second.



Note

- If reading of card completes, the door opens and 😊 icon will light up on the user-friendly graphic interface.
- If reading of card fails, ✖ icon will light up on the user-friendly graphic interface.

# How to Open and Close the Door from Inside

## Opening Door Electronically

🔊 ↑Ding dong dang dong



Open the locked door from the inside by pressing [Open/Close] button on the inner body.

## Closing Door Electronically

🔊 ↓Ding dong dang dong



At manual-lock mode, close the door from the inside and then lock the door by pressing [Open/Close] button on the inner body.

## Opening Door Mechanically

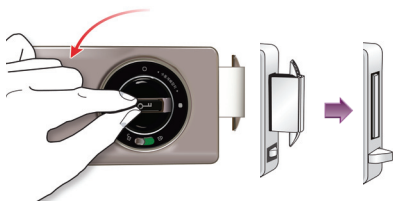

Open the door by turning the manual open/close handle counterclockwise until the green color shows.

## Closing Door Mechanically

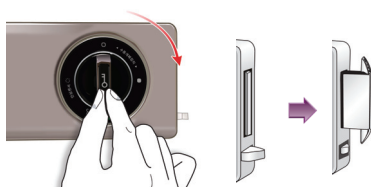

Close the door from the inside and then lock the door by turning the manual open/close handle clockwise until the red color shows.

# Additional Functions

## How to Set up Multi-levelled Security Code Entry Mode

Multi-levelled security code entry mode uses 2 random numbers and password to secure the password from being exposed.

To suit your needs, you can switch between normal mode and Multi-levelled security code entry mode.

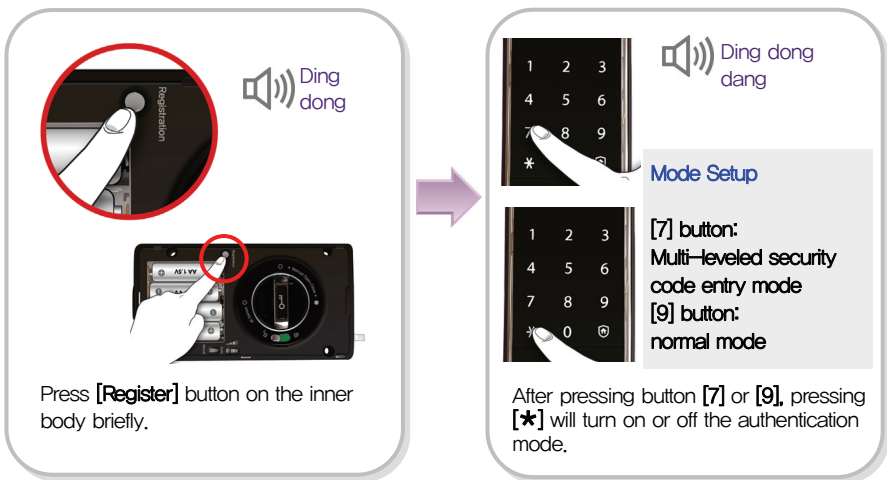

Note

- Setting up multi-levelled security code entry mode can be done only when the door is open.
- If the procedure for setting up Multi-levelled security code entry mode completes, 😊 icon on the user-friendly graphic interface will light up.
- When purchased, the product is initially set to Multi-levelled security code entry mode.



# How to Set up Infrared Ray Sensor

Infrared ray sensor detects movement on the inside with an infrared ray when the door opens by pressing [Open/Close] button. It prevents the door being opened by abnormal methods. You can either set up or cancel the function for your convenience. (When purchased, this function is not activated.)



Press [**Register**] button on the inner body briefly.

**Sensor Setup**

[1] button:  
Infrared ray sensor on

[3] button:  
Infrared ray sensor off

After pressing button [1] or [3], pressing [**\***] will turn on or off the infrared ray sensor function.

## Sensor Mechanism



Infrared ray sensor detects movement on the inside when the door opens by pressing Open/Close button on the inner body, and the door opens.

If an abnormal method is used from the outside to open the door, the sensor does not detect movement inside, and the door will not open.



Note

- With the sensor being setup, press Open/Close button and check if the infrared sensor works properly by checking the Infrared ray sensor LED lights up on the inner body.
- With the infrared ray sensor being setup, the door will not open unless the sensor detects any movement inside.
- The sensor's infrared detection works at the height of the infrared ray sensor LED light, and it may not work properly when a small child tries to open the door. Be sure you set up the function with that in mind.
- This function may differ depending on the differences in installation environments.
- Setup of infrared ray sensor function only works when the door is open.
- When purchased, this function is not activated.

# How to Set up Double Authentication Mode

Double authentication mode requires both card and password to open the door, ensuring more security. You can either set up or cancel the function for your convenience.

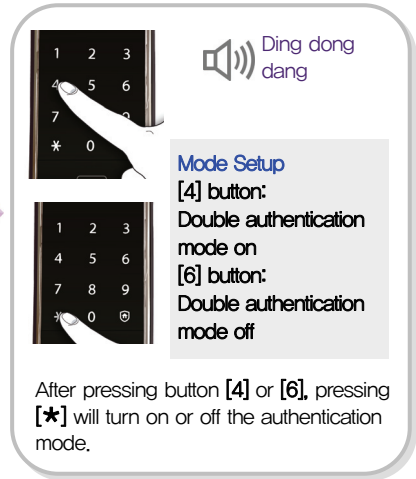

## Turning on Double Authentication Mode

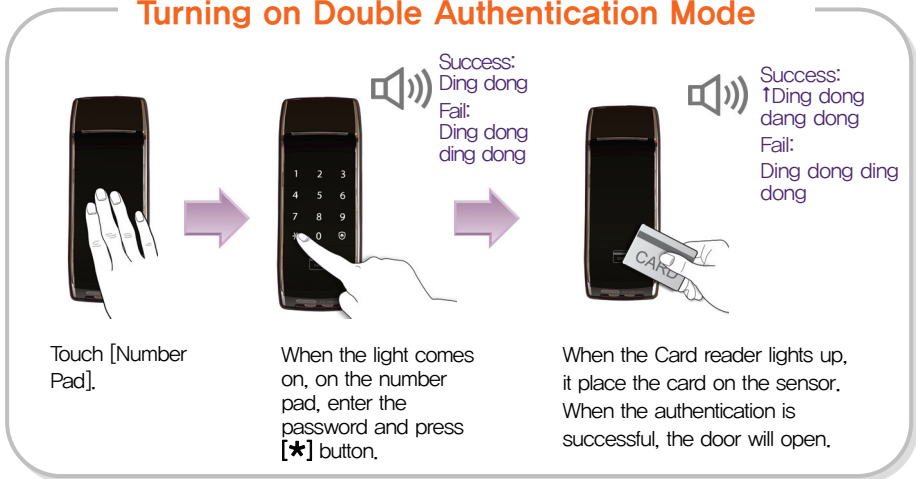

Note

- Setting up double authentication mode can be done only when the door is open.
- When purchased, double authentication mode is not activated.
- To setup the double authentication mode, more than 1 card must be registered.
- Double authentication mode will automatically be turned off when all card information is deleted.

# How to Set up Auto/Manual Lock

When the door is closed, auto-lock function can be setup.

## Setting up Auto-lock



Place [Auto/Manual Lock] switch on the inner body to 'Auto'.

## Setting up Manual Lock



Place [Auto/Manual Lock] switch on the inner body to 'Manual'.



Note

### Difference between Auto-lock and Manual-lock

- Auto-lock: the door will lock in 2 seconds after the door closes.  
However, if the battery is completely discharged, the product will not function.
- Manual-lock: the door does not lock automatically, touch [Number Pad] or [Open/Close] button on the inner body must be pressed to lock the door.



Caution

- The door will not lock automatically if the door is set to manual lock, so please make sure you lock the door for your safety.



Note

- If the deadbolt comes out automatically when the open-door sensor is pressed by hand while the door is open, then the auto-lock function is on.
- If the door is opened while auto-lock is on, warning sound “pee pee pee” will ring twice every 15 seconds. (The warning sound will not ring while manual-lock is on.)
- After lock is released using password, a card or key tag, if the door is not open within 7 seconds from being unlocked, it will be re-locked.

# How to Set up and Turn off Sound

The sound volume for entering password, closing and opening the door can be adjusted.

## Setting up Sound Function

When purchased, the product is set so that all sounds are turned on initially.

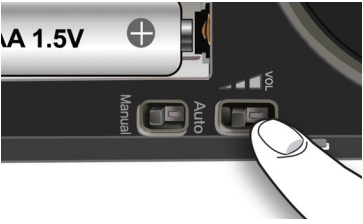

The diagram shows a close-up of the sound volume control area. A 1.5V battery is inserted into the top. Below it, there are two switches labeled 'Manual' and 'Auto'. To the right of these switches is a volume control knob with a 'VOL' label and a scale. A finger is shown moving the volume control knob from the 'Auto' position to the 'Level 1' position.

**Sound function**

☐ : Mute    ▲ : Level 1    ■ : Level 2

Place [Sound Volume] switch at the place between [ ▲ ] and [ ■ ].



Note

### Operation of Sound Function

- [ ☐ ] : No sound will ring (except the warning bell)
- [ ▲ ] ~ [ ■ ] : All sounds will ring and will get louder as the level increases.
- At setup mode, the sound may not be the one the user wants, the sound selected is heard when the setup is completed.

# Warning Alarm / Emergency Alarm

## When the Alarm Sounds (Tempering–prevention function)

It is a function that stops doorlock with the warning alarm when the lock is not properly treated from the outside.

### Card/ Password Error



When trying to open the door with an unregistered card or the password is entered 5 times incorrectly.

(After the warning bell, door lock will not work for 3 minutes. During stop mode, "beep" will sound in every 10 seconds, and stop mode will be turned off automatically after 3 minutes with multiple 'beeps'. With stop mode, the user-friendly graphic interface will show the duration time by turning off [★] icon one at a time every 30 seconds.)

## How to Turn off the Alarm

[Inside]

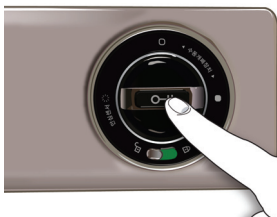

Press [Open/Close] or [Register] button on the inner body or take batteries out.

[Outside]

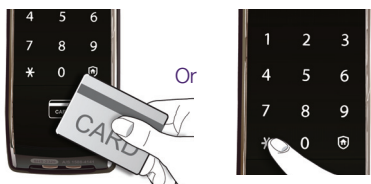

Place a registered card, key tag or enter password.  
(Turning off the alarm sound is only allowed within 10 seconds after bell starts ringing).

## How to Set up Anti-theft Function

It is a function that prevents intrusion attempts from the outside by sounding an alarm if the door lock is manipulated inside.

### Setting up Anti-theft Function



When the door is closed [🔒] of the outside body's number pad will light up.



Ding dong dang



Pressing the [🔒] button within 3 seconds activates the anti-theft function.



Note

- Anti-theft will automatically shut off if a registered password is entered or a registered card is used.

### Anti-theft function

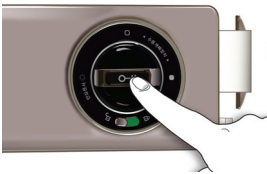

[Inside]



Peep~ Peep~ Peep~  
(for 5 minutes)

If [Open/Close] button is pressed from the inside while the anti-theft function is on, alarm will sound for 5 minutes.

### Turning off anti-theft function



Or



[Outside]

After placing a registered card or key tag or entering password, press [\*] button.

## Intruder Detection Function

It is a function that rings the alarm for a forced entry from both inside and outside of the room. (With default functions, it cannot be turned on or off separately).

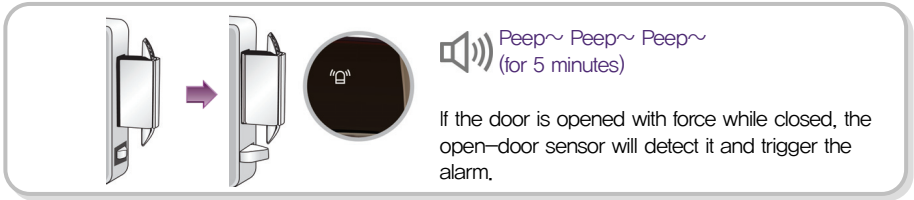

## How to Turn off Emergency Alarm



## Built-in Fire Detection Feature

In case of a fire, this function allows a prompt exit by sounding an alarm. (Built-in fire detection has been set as default, and user cannot turn it off.)

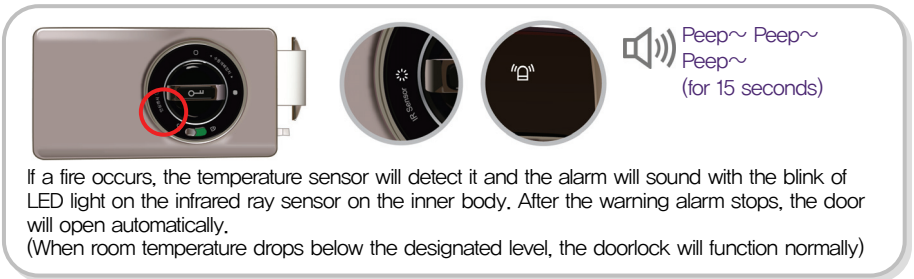

Note

- The built-in fire detection feature operates at around 65°C, although there may be some differences depending on the environment.

## How to Use Double Lock

Double lock is to allow no outsider to open the locked door.

**Setting up Double Lock**

[Inside]



Slide the double lock lever until you see the red color (🔒) from the inside while the door is locked.

**Turning on Double Lock**

[Inside]



[Outside]

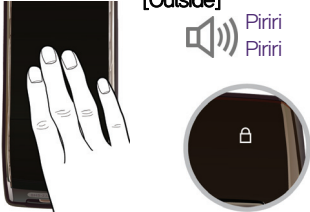

Piriri  
Piriri

Piriri  
Piriri

With double lock function on, the door will not open from the inside if you press [Open/Close] button. But, you can open the door by turning the manual open/close handle counterclockwise.

When you touch [Number Pad], the double lock bell ring, LED for double lock will turn on, and door will not be opened.

**Turning off Double Lock**

[Inside]



[Inside]



Check if double lock lever is on the side showing red (🔒).

Slide double lock lever to the side showing red (🔒) completely.



### Caution

- You cannot open the door while double lock is on from the outside. Please make sure that children do not randomly change the settings from the inside
- When the door is open, if double lock is set up and the door is closed, a warning sound (Peep Peep Peep) rings for a minute and the door will not be locked. The door will lock after double lock is turned off and the door is closed.



# Troubleshooting

If door lock part does not work properly, check the listed cases below.  
Contact your nearest customer support center if the problem continues.

## Power

Problem	Troubleshooting	Reference
Power is not coming on.	<ul style="list-style-type: none"> <li>– Please check to make sure the battery is functional and that it is placed in the correct position.</li> <li>– Check if the battery is inserted in the correct way or if it is completely discharged.</li> </ul>	Pages 10~11



## Password/Card/Key Tag

Problem	Troubleshooting	Reference
Cannot change password.	<ul style="list-style-type: none"> <li>– It is situation where time has passed without changing the password. The light on the [number pad] must be on while you are changing the password. The next number must be entered within 10 seconds after the first one.</li> <li>– If the batteries are discharged, please replace them.</li> <li>– Refer back to User Guide's 'How to Register Password' section and try again.</li> </ul>	Pages 13~14
Cannot register card or key tag.	<ul style="list-style-type: none"> <li>– To register multiple cards or key tags, after place the first one on the sensor, and place next one within 10 seconds.</li> </ul>	Pages 15~16
Cannot open the door after entering password and pressing [★].	<ul style="list-style-type: none"> <li>– Check if the registered password has been entered correctly.</li> <li>– Password must be entered when the light is on or else it will not work. If it does not, touch [Number Pad] and re-enter while the light is on. (The backlight on the number pad will turn off automatically if untouched for 5 seconds.)</li> </ul>	Pages 18
Cannot open the locked door with card or key tag.	<ul style="list-style-type: none"> <li>– It is the case where either the card is not registered or not read correctly. Reregister the card/key tag and try to open the door again.</li> <li>– Make sure that you place card or key tag is properly placed on the sensor.</li> </ul>	Pages 19

Problem	Troubleshooting	Reference
Cannot open the door using password or the card/key tag.	<ul style="list-style-type: none"> <li>– You can not open the door with password, a card or key tag while the double lock system is on. Touching [Number Pad] will ring the warning sound while the double lock system is on.</li> <li>– When double lock lever is placed at the direction of , it is in double lock status.</li> </ul>	Pages 29
Password and card/key tag cannot open the door though registered.	<ul style="list-style-type: none"> <li>– There might be an error with locking system. Contact the customer support center.</li> </ul>	–



## Auto-lock

Problem	Troubleshooting	Reference
The door will not lock automatically even after closed.	<ul style="list-style-type: none"> <li>– Check if the system is in auto-lock mode. In manual-lock, touching [Number Pad] will lock the door.</li> <li>– If the door is not locked in auto-lock mode, the door lock is not installed properly. See digital doorlock retailer for the reinstall.</li> <li>– Auto locking function does not work when the battery is completely discharged. See if it is in the case..</li> </ul>	Pages 24



## Warning Alarm

Problem	Troubleshooting	Reference
"Piriri" warning bell and user-friendly interface  LED light up when (Number Pad) is touched.	Touching [Number Pad] will ring the warning sound while the double lock system is on. Please check if it is on and turn it off before use.	Pages 29
When door lock operates, the melody (Fur Elise) will be played continuously.	The sound indicates the need for a battery change. Please replace the batteries within a week.	Pages 10~11











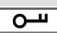











## Malfunction

Problem	Troubleshooting	Reference
No response after touching (Number pad).	<ul style="list-style-type: none"> <li>– On the right side of the emergency power supply, there is a hole and press it with a pin.</li> <li>– If the above does not work, please contact customer service center.</li> </ul>	–

# Summary of Usage

※ Reset, register or change, and delete are only allowed while the door is open.

Function	Default Value	Setting Up or Turning Off (Press in Order)
Resetting (deleting Password, Cards and Key Tags)	—	Registration ● button for 10 seconds → Password or the number '4560852580' → * button ※ The password after reset is '1234'.
Registering/Changing Password	Current password or '1234'	Registration ● button → Current password + * button → New password + * button → New password again + * button
Registering Card/Key Tag	None	Registration ● button → Password + * button → Card/Key Tag reading → Registration ● button
Deleting All Card/Key Tag	None	Registration ● button for 5 seconds → Password + * button
Opening Door from Inside	—	Electronic) Press  while locked → Door opens Mechanical) Manual Open/Close handle counterclockwise → Door opens
Closing Door from Inside	—	Electronic) Press  while open → Door closes Mechanical) Manual Open/Close handle clockwise → Door closes
Opening Door from Outside	Multi-leveled Security code entry mode & Double Authentication Off	Card: Touch (Number Pad) → Read Card/Key Tag in 5 seconds Password: Touch (Number Pad) → 2 random numbers → Password → * button
Closing Door from Outside	—	Auto-lock: Close and locks automatically Manual-lock: Touch (Number Pad)
Multi-leveled Security Code Entry Mode Setup	Multi-leveled Security Code Entry Mode	Registration ● button →  + * button
	Normal Mode	Registration ● button →  + * button
Double Authentication Setup	On	Registration ● button →  + * button
	Off	Registration ● button →  + * button

Function	Default Value	Setting Up or Turning Off (Press in Order)
Auto-Lock Setup	Auto-Lock	"Auto"  position for Auto/Manual lock switch
Manual Lock Setup		"Manual"  position for Auto/Manual lock switch
Setup and Turning Off Sound	–	(Sound Volume) switch to [  , [  , [  ] position
Infrared Ray Sensor	On	Registration  button → [  ] + [  ] button
	Off	Registration  button → [  ] + [  ] button
Setting up anti-theft function	–	Press [  ] button within 3 seconds after the door is locked.
Turning off anti-theft function		Enter password or read card or key tag
Turning Off the Alarm from the Inside	–	Press Registration  button
Turning Off the Alarm from the Outside		Enter password or read card or key tag
Setting Up Double Lock Function	–	Double Lock Lever to  direction while locked
Turning Off Double Lock Function	–	Double Lock Lever to  direction

# Product Specifications

Category	Specifications	
Standard Power Source	4 AA Alkaline batteries (1.5V, LR6) (6V)	
Emergency Power	9V battery (6LF22) (not included)	
Working Mechanism	Electronic control system (enter password or read card or key tag)	
Weight	1.7 kg (including both inner body and outer body)	
Product Size	Inner Body	65,2 mm(W)×170,5 mm(H)×22,5 mm(D)
	Outer Body	182,0 mm(W)×90,0 mm(H)×40,7 mm(D)

## RF Specifications

Frequency	Wave Type	Modulation Type	Communication Type	Operation Environment	Numbers of Channel
13,56MHz	A1D	ASK	Single	Temperature: -10℃ ~ +50℃ Humidity : 95%	1 channel

The contents of the User Guide may be changed without prior notification for the purpose of enhancing the product usage.

# LIMITED PRODUCT WARRANTY

## Installation of the product is considered acceptance of warranty conditions

SAMSUNG SDS CO., LTD (SAMSUNG SDS) warrants its products to be free from manufacturing defects in materials and workmanship for 12 months from the date of purchase. SAMSUNG SDS will, within said period, at its option, repair or replace any product failing to operate correctly without charge to the original purchaser or user.

This warranty shall not apply to any equipment, or any part thereof, which has been repaired by others, improperly installed, improperly used, abused, altered, damaged, subjected to acts of God, or on which any serial numbers have been altered, defaced or removed. SAMSUNG SDS does not warrant the performance or sale conditions of the seller/installer.

There are no warranties, express or implied, which extend beyond the description on the face hereof. There is no express or implied warranty of merchantability of a warranty of fitness for a particular purpose. Additionally, this warranty is in lieu of all other obligations or liabilities on the part of SAMSUNG SDS.

Any action for breach of warranty, including but not limited to any implied warranty of merchantability, must be brought within the six months following the end of the warranty period. In no case shall SAMSUNG SDS be liable to anyone for any consequential or incidental damages for breach or this or any other warranty, express or implied, even if the loss or damage is caused by the seller's own negligence or fault.

SAMSUNG SDS shall have no obligation under this warranty, or otherwise, if the product has been repaired by others, improperly installed, improperly used, abused, altered, damaged, subjected to accident, nuisance, flood, fire or acts of God, or on which any serial numbers have been altered, defaced or removed. SAMSUNG SDS and its distributor will not be responsible for any dismantling, reassembly or reinstallation charges. This warranty contains the entire warranty. It is the sole warranty and any prior agreements or representations, whether oral or written, are either merged herein or are expressly cancelled. SAMSUNG SDS neither assumes, nor authorizes any other person purporting to act on its behalf to modify, to change, or to assume for it, any other warranty or liability concerning its products. In no event shall SAMSUNG SDS be liable for an amount in excess of SAMSUNG SDS's original selling price of the product, for any loss or damage, whether direct, indirect, incidental, consequential, or otherwise arising out of any failure of the product. Seller's warranty, as hereinabove set forth, shall not be enlarged, diminished or affected by and no obligation or liability shall arise or grow out of Seller's rendering of technical advice or service in connection with Buyer's order of the goods furnished hereunder.

SAMSUNG SDS recommends that the entire system be completely tested weekly.

Warning: Despite frequent testing, and due to, but not limited to, any or all of the following; criminal tampering, electrical or communications disruption, it is possible for the system to fail to perform as expected. SAMSUNG SDS does not represent that the product/system may not be compromised or circumvented; or that the product or system will prevent any personal injury or property loss by burglary, robbery, fire or otherwise; nor that the product or system will in all cases provide adequate warning or protection. A properly installed and maintained alarm may only reduce risk of burglary, robbery, fire or otherwise but it is not insurance or a guarantee that these events will not occur.





Consequently, seller shall have no liability for any personal injury, property damage, or other loss based on a claim the product failed to give warning.

Therefore, the installer should in turn advise the consumer to take any and all precautions for his or her safety including, but not limited to, fleeing the premises and calling police or fire department, in order to mitigate the possibilities of harm and/or damage. SAMSUNG SDS is not an insurer of either the property or safety of the user's family or employees, and limits its liability for any loss or damage including incidental or consequential damages to SAMSUNG SDS's original selling price of the product regardless of the cause of such loss or damage.

Some states do not allow limitations on how long an implied warranty lasts or do not allow the exclusion or limitation of incidental or consequential damages, or differentiate in their treatment of limitations of liability for ordinary or gross negligence, so the above limitations or exclusions may not apply to you. This Warranty gives you specific legal rights and you may also have other rights which vary from state to state.

In case of the product defect, contact our authorized Customer Service Center. In order to exercise the warranty, you must contact our authorized Customer Service Center and obtain a proper RMA # - the product must be returned to our authorized Customer Service Center at user's shipping expense and the replacement product will be shipped back at our expense.

For product service, the product in all cases must be accompanied by below warranty form. Customer must ask the reseller or installer to fill out the warranty form indicated below, otherwise the product warranty may be considered void.

Visit our website at [www.samsungsds-nss.com/en](http://www.samsungsds-nss.com/en) and go to Support menu to find the contact information of our worldwide distributors.

---

Date of Purchase or Installation : \_\_\_\_\_ (MM/DD/YY)

Name, telephone and full address of purchaser : \_\_\_\_\_

\_\_\_\_\_  
\_\_\_\_\_

Stamp or Signature of authorized reseller / installer

Product Code and Serial Number :

\_\_\_\_\_  
\_\_\_\_\_









# Set up Instructions for Alarm and Anti unlock functions

## Alarm function

When this function is activated, an alarm sound and light will turn on for approximately 5 minutes duration.

## Anti-Bypass function

When this function is activated, the internal handle will become tightened to prevent bypass attempts through door edge tools will be minimized.

### Set up the Alarm function

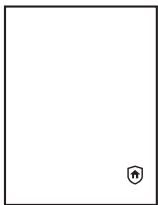

When the door is closed, user can set up the alarm function by pressing and holding the [🛡️] button for 3 seconds until sound confirmation.

### Set up the Anti-Unlock function

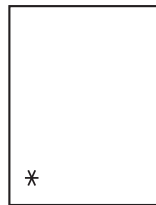

Press [\*] and hold.  
After 3 seconds, the alarm will be come active.

### Release the Alarm function

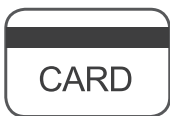

OR

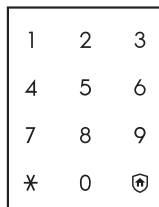

Touch the keypad to turn on.  
Present a registered RF tags/card or password and press [\*] to release.

### Release the Anti-Bypass function



Press the [CLOSE] button to release the internal handle from Anti-Bypass function.

When this function is active, it may be harder to pull the internal handle for elderly or children to open the door from inside.



Warning

- Anti-Bypass function should only be set up when there is no one inside.

# 安防，防止外部强制开门功能 设定/解除

## 安防功能

外出时防止外部入侵的功能，当有人在室内对电锁进行操作时发出报警音。

设置安防功能状态下，若有人在室内开门，室外侧紧急报警灯会闪动同时持续5分钟发出“哔~哔~哔~”的报警音。

## 防止外部强制开门功能

外出时防止他人以非正常手段操作室内门锁把手，通过机械式再次锁定防止外部人员强制开门的功能。

## 安防功能设定

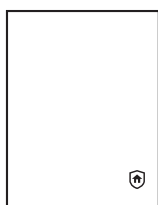

关门后室外侧按键板的[🔒]按键会亮灯，3秒内按下[🔒]按键完成安防功能设定。

## 防止外部强制开门功能设定

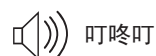
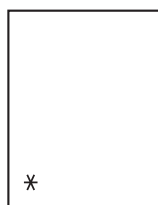

安防功能设定后3秒内按下[\*]按键完成防止外部强制开门功能设定。

## 安防功能，防止强制开门功能，解除报警音

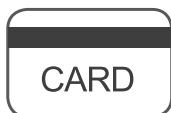

或者

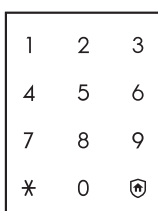

触摸按键板后进行刷卡或者输入密码，随后按下[\*]按键。

## 解除防止室内强制开门功能



若在室内有人的情况下设置了防止外部强制开门功能，老弱者开门会比较吃力可以按下[CLOSE]键解除机械式的锁定状态后轻推把手即可开门，此时会发出“哔~哔~哔~”的报警音。



注意

- 防止外部强制开门功能必须在家里没有人的情况下设定使用。