

## Model 061

A vertical sliding system with synchronised opening and closing based on a rack system. May be used for sliding cupboard doors in any material and up to a maximum weight of 20 kg per door. The two aluminium Slides are installed on the side of the cupboard, while the doors are mounted on special sliding brackets. The path of the door depends on the length chosen for the Slides, up to a maximum of 954 mm.

### FINISH

- Natural anodised aluminium

### Sliding on ball bearings

Code	A	B	C	D
061.1150.22	1150	300	500	100
061.1350.22	1350	300	700	100
061.1377.22	1377	300	677	100
061.1390.22	1390	300	750	100
061.1408.22	1408	300	750	100
061.1424.22	1424	300	800	100
061.1435.22	1435	300	800	100
061.1450.22	1450	300	800	100
061.1550.22	1550	300	900	100
061.1571.5.22	1571,5	300	800	100
061.1597.22	1597	340	900	140
061.1600.22	1600	300	778	100
061.1648.22	1648	300	577	100
061.1750.22	1750	400	900	200
061.1932.22	1932	400	954	200
061.1949.22	1949	400	954	200
061.2098.22	2098	400	900	200
061.2121.22	2121	300	714	100

### Sliding on Delrin wheels

Code	A	B	C	D
061.1150.22 E	1150	300	500	100
061.1350.22 E	1350	300	700	100
061.1377.22 E	1377	300	677	100
061.1390.22 E	1390	300	750	100
061.1408.22 E	1408	300	750	100
061.1424.22 E	1424	300	800	100
061.1435.22 E	1435	300	800	100
061.1450.22 E	1450	300	800	100
061.1550.22 E	1550	300	900	100
061.1571.5.22 E	1571,5	300	800	100
061.1597.22 E	1597	340	900	140
061.1600.22 E	1600	300	778	100
061.1648.22 E	1648	300	577	100
061.1750.22 E	1750	400	900	200
061.1932.22 E	1932	400	954	200
061.1949.22 E	1949	400	954	200
061.2098.22 E	2098	400	900	200
061.2121.22 E	2121	300	714	100

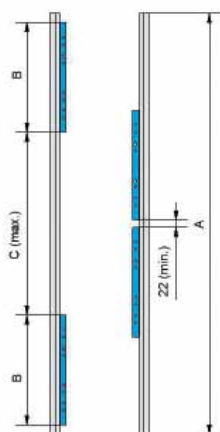
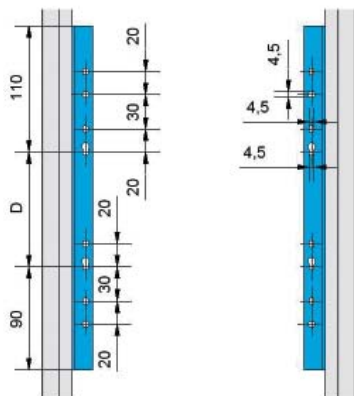

A= Length of slide  
 B= Length of lug  
 C= Opening  
 D= Centre distance

Any measurement and opening may be made at the request of the customer

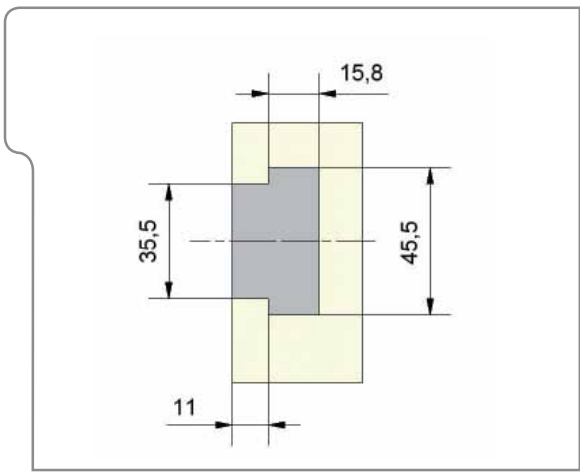

Shape and size of Slides based on side of cupboard.

	A	B	C
Slide completely recessed	B+23 mm	Door thickness +0.5 mm	11,5
Slide partially recessed	B+23 mm	Door thickness +0.5 mm	22,5
Slide visible	B+23 mm	Door thickness +0.5 mm	38

## POSITION OF Slides

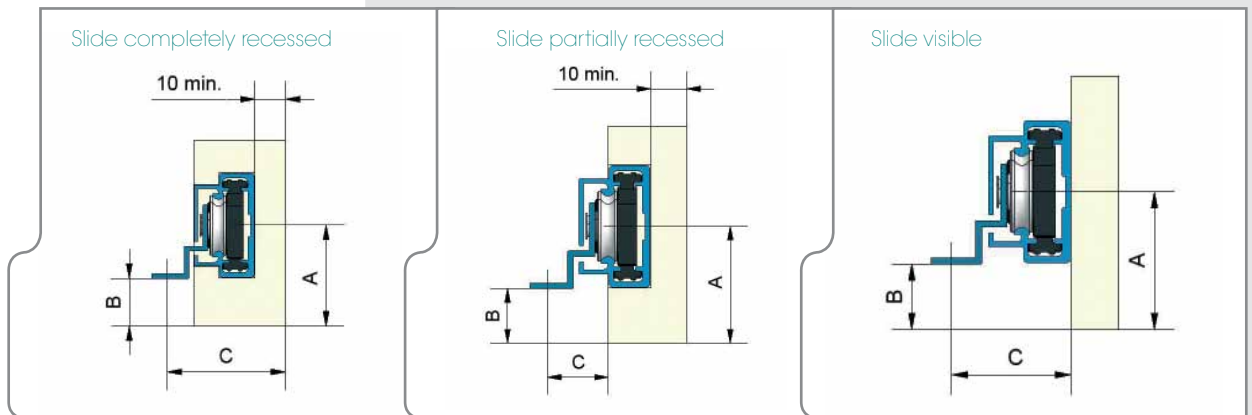

## POSITION OF DOORS

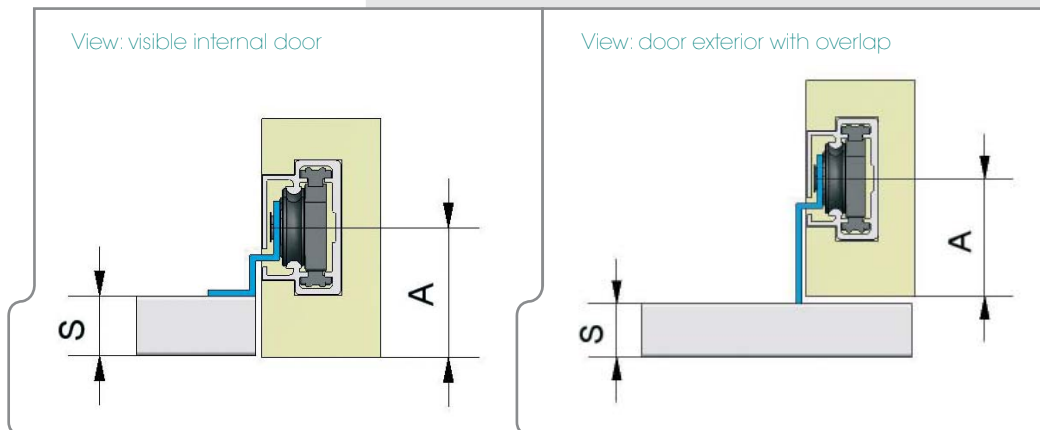

## ASSEMBLY

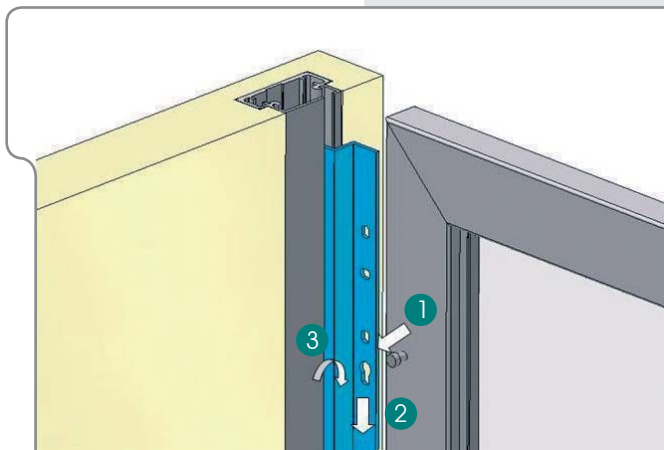

Insert the two Slides into the grooves in the side panels of the cupboard. Once the cupboard structure is assembled attach the door to the bracket by screwing the screws into the slots **1** and fitting the door **2** onto them. Check that the doors are parallel and, once in the correct position, tighten the screws **3**. For greater stability of the door additional holes may be made in the bracket.